



SmartPIN B100™

PCI 3.x Certified Modular PIN Entry Device

Encrypted PIN Entry for Banking and POS

The SmartPIN B100 is a PCI 3.x certified PED (PIN Entry Device) designed for outdoor unattended POS operations where encrypted PIN entry is required.

Applications

The SmartPIN B100 can be used in ATMs, fuel dispensers, kiosks, vending machines, and other POS systems that accept credit and debit payments.

A Secure and Rugged PED

ID TECH's SmartPIN B100 is PCI compliant and certified for the highest degree of PIN security. The SmartPIN B100 supports TDES encryption algorithm using DUKPT key management and Master/Session. The SmartPIN B100 is robust and vandal resistant with waterproof keys to withstand splashed, spilled, & direct liquid spray. The molded metal body and stainless steel cover, along with metal engraved keys, allow the PIN pad to be used in unattended environments. The built-in battery maintains the cryptographic keys during power outage and storage.

Secure Communication and Operation

The 16-key PIN pad is ADA compliant and it offers tactile and audio feedback with each keystroke. PIN entry is encrypted and securely transmitted over the RS232 or USB-HID communication interface.

Features and Benefits:

- Payment Card Industry (PCI 3.x) Certified
- Meets ADA, ANSI and ISO standards for a PIN Entry Device (PED)
- 4 screw holes and built-in gasket for watertight mounting
- IP65 rated
- Removal detection and tamper resistant
- Secure scheme for authorized activation/installation
- TDES encryption algorithm
- Clear and encrypted text input
- Key management: Master/Session, DUKPT
- Rugged, vandal resistant for outdoor, indoor & unattended applications

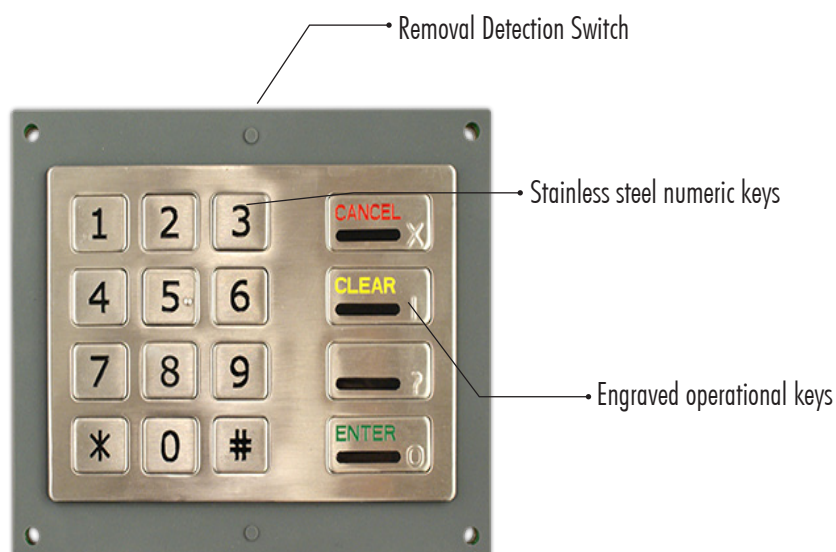

IDTECH®
Value through Innovation

SmartPIN B100™

Specifications IDPB-70X000

Electrical

Power Requirements: 5VDC, $\pm 10\%$, 180mA maximum
Interfaces: RS232 or USB-HID

Environmental

Operating Temperature: -13°F to 158°F (-25°C to 70°C)
Storage Temperature: -22°F to 149°F (-30°C to 65°C)
Humidity: Maximum 95% non-condensing

Reliability

Operating Life: Minimum 2,000,000 operations
MTBF: 120,000 power-on hours calculated
ESD Immunity: Minimum 4KV direct contact & 8KV air discharge without resetting
Approvals: FCC and CE
Warranty: One year, parts and labor

Mechanical

Dimension (L)x(W)x(H): 5.94 inches (151 mm) x 4.80 inches (122 mm) x 1.10 inches (27.9 mm)
Weight: 23.86 oz. (1.49 lbs)
Keys: Numeric (12), Operation (4)

Footprint:

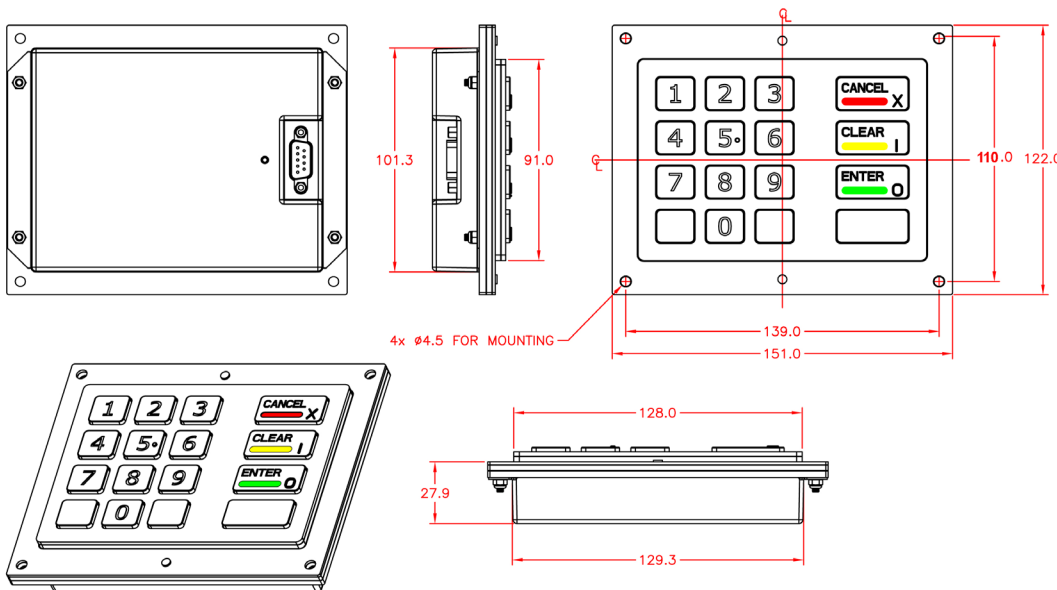

United States Sales Office

Corporate Headquarters

10721 Walker Street
Cypress, CA 90630
Phone: (714) 761-6368
Toll Free: (800) 984-1010
Fax: (714) 761-8880
sales@idtechproducts.com

International Sales Offices

Asia

+866-3-326-5988 (Taiwan)
asia@idtechproducts.com.tw

Canada

(416) 519-8529
martinm@idtechproducts.com

South America

+55-11-3079-2255
internationalsales@idtechproducts.com

Europe, Middle East and Africa

+011-44-1925-269550
emea@idtechproducts.com

ISO 9001 Certified
ISO 14001 Certified

IDTECH®
Value through Innovation

www.idtechproducts.com